



NEW ARK90 RGB MB Cable

User's Guide for switching to MB Control RGB

www.gamerstorm.com

GAMER STORM

Patent Pending

www.gamerstorm.com

Beijing Deepcool Industries Co., Ltd.
Building 10, No. 9 Dijin Road, Haidian District, Beijing 100095, China

"GAMER STORM", "九州风神", "九州风神" and other commercial identities are legitimate registered trademarks and commercial identities of the trademarks owner and its affiliates in China and other countries or regions.
Copyright © 2018 Beijing Deepcool Industries Co., Ltd. All rights reserved.

Accessories List

RGB MB Cable × 1	RGB Extension Cable × 2	User Guide × 1

1. Disconnect all RGB devices from the cables of Button Controller.

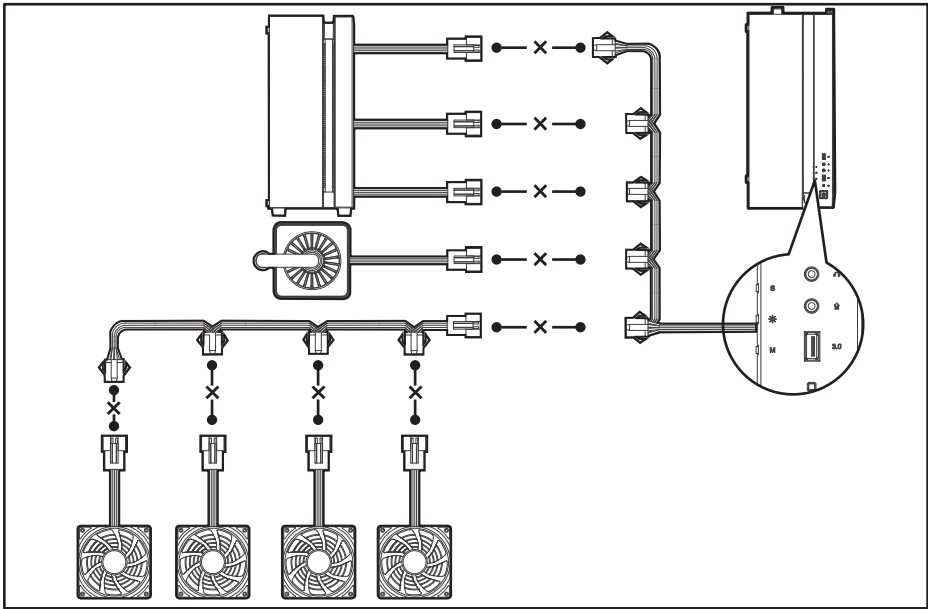

2. Connect all RGB devices with the 2 RGB Extension Cables as indicated.

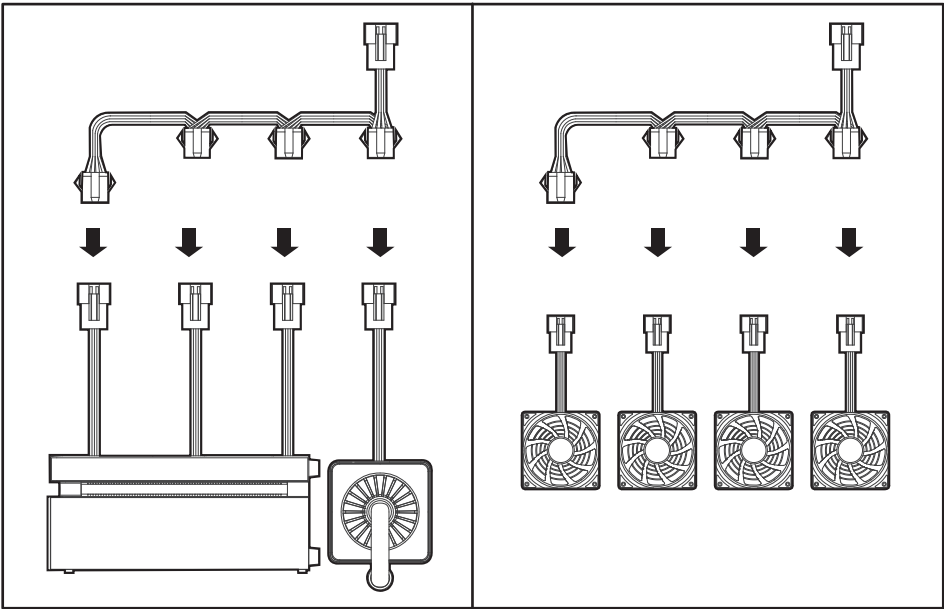

3. Connect the 2 RGB Extension Cables with RGB MB Cable.

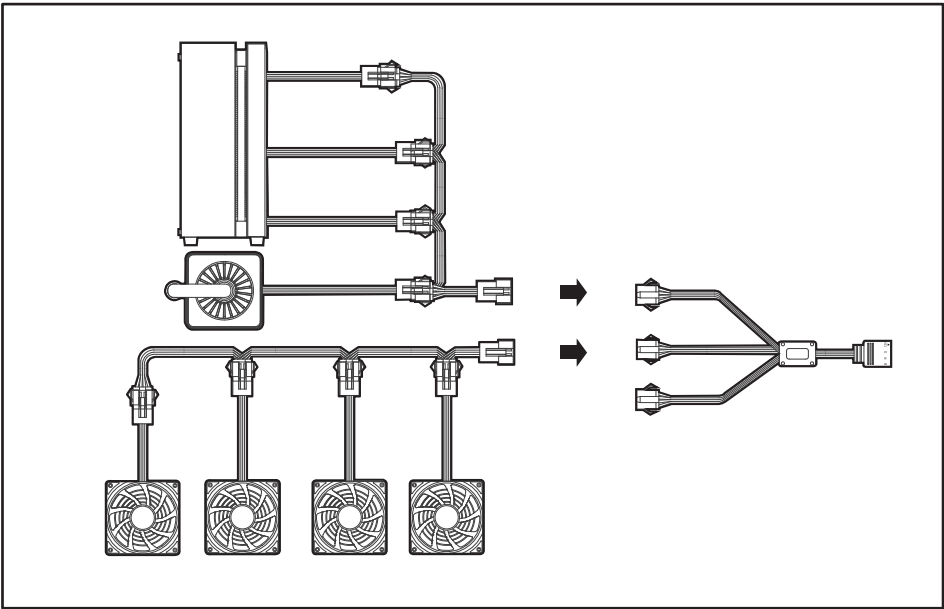

4. Connect another end of RGB MB Cable with the RGB_HEADER on Motherboard.

